

### PLUMBERS INSTALLATION INSTRUCTIONS

#### Important

- \* Hand Shower (1) is fitted with flow regulator (2). This lower flow rate may not be suitable for connection to some gravity fed Water Heaters, low pressure supply networks, Instantaneous Water Heaters, Tempering Valves, Solar Water Heaters & Thermostatic Mixing Valves. Check with the manufacturers of these products. Note: Warranty is void if flow regulator (2) is not installed as shown.
- \* Not suitable for gravity feed systems.
- \* All pipework must be thoroughly flushed prior to installation, as foreign materials may block the flow regulating device and reduce the flow of water.
- \* Wall elbow (10) must be installed with threaded spigot pointing downwards and holder (11) towards the right.

#### Installation

- 1) Check that threaded nipple (14) is the correct length as shown. Cut to length if required ensuring end face is square. Apply thread tape to the thread.  
**Important** : Care must be taken that thread tape cannot become dislodged and block the flow regulating device, causing a reduction in water flow.
- 2) Fit 'O'ring (13) into cover plate (12). Locate the cover plate on the wall elbow (10) then screw the elbow (10) onto threaded nipple (14) & tighten until the cover plate is secured against the wall/tile face and the outlet thread is pointing downwards. DO NOT OVERTIGHTEN.
- 3) Check that rubber washer (9) is installed into the shorter conical fitting (8) of shower hose (7) then screw onto the thread of wall elbow (10) and tighten. Ensure the check valves (4) are fitted into handset (1) and the strainer washer (5) is fitted into the longer conical end of shower hose (8), then screw onto handset (1) and tighten. Fit handshower (1) into holder (11).  
**Note**: The Handshower spray can be adjusted between "Firm" & "Gentle" by moving the slider on hand shower handle up and down.

<b>IMPORTANT</b>	
<b><u>Pressure &amp; Temperature Requirements.</u></b>	
•	Hot and cold water inlet pressures should be equal.
•	Static inlet pressure range : 150 - 1000 kPa New Regulation :-500 kPa maximum static pressure at any outlet within a building. (Ref. AS/NZS 3500.1)
•	Maximum hot water temperature : 80°C.
<b><u>Installation Requirements.</u></b>	
•	The installing plumber is responsible for waterproofing all penetrations for Taps in Shower areas at installation by a proprietary flange system or a sealant. (Ref AS3740)

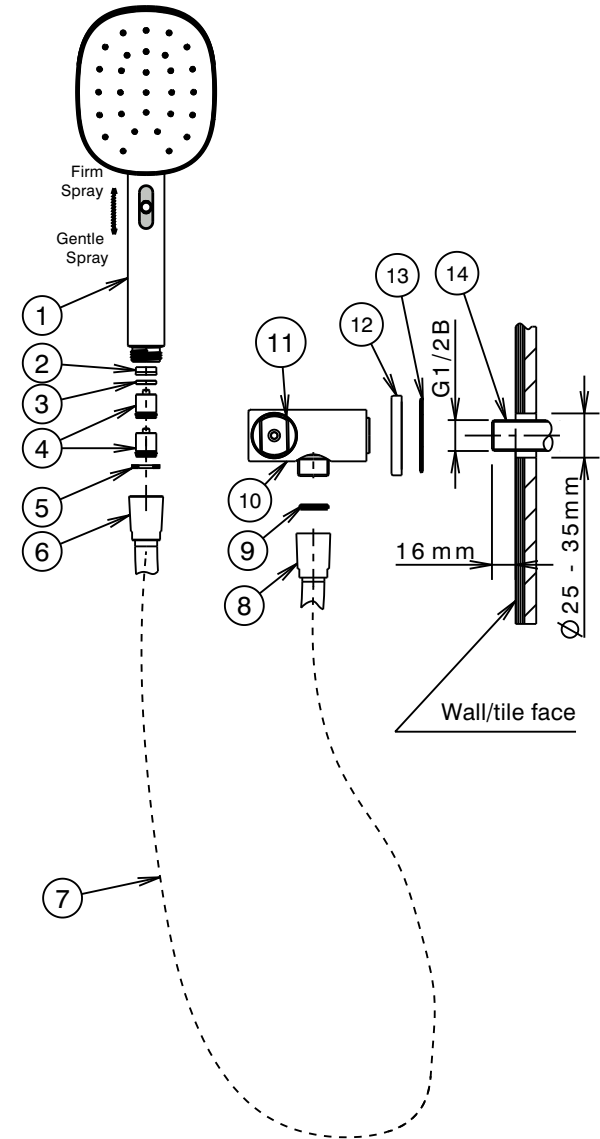

Fig. 1