

# Aquatica

## Sink Mixer Stainless Steel

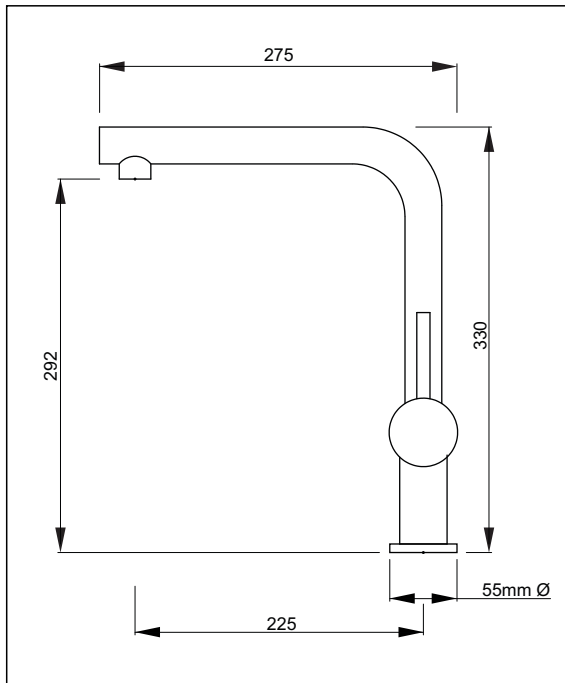

**Code: AQ SM SS**

**Finish:** Stainless Steel

**Spout:** Swivel 360°

**Water Outlet:** M24 ring with PCA fitted

**Stainless Steel Inlet Hoses:** Size: M8 x 1/2" BSP  
Length: 550 mm

**Mounting Hardware:** Stud: 34 mm Stainless Steel tube washer and backnut with two 6 mm screws

**Installation Hole Diameter:**

Minimum: 34 mm

Maximum: 42 mm

Max bench thickness: 57 mm

**Cartridge:** Kerox 40K Flat Base

**Flow:** Max Hot @ 35 kPa = 3.9 l/min

**Flow Control:** 8 l/min PCA fitted for regulated flow with mains pressure system

aquatica



KIWI OWNED COMPANY

NZ

• DESIGNED  
• ASSEMBLED  
• TESTED



**Aquatica NZ Limited**

9 Saunders Place,  
Avondale, Auckland.

Tel: 09-828 2068,

Fax: 09-828 2069

Email: [info@aquatica.co.nz](mailto:info@aquatica.co.nz)  
or visit our website:

[www.aquatica.co.nz](http://www.aquatica.co.nz)

© copyright Aquatica 2019

### Suitable for mains pressure only

Recommended Operational Pressure Range: 150 - 600 kPa  
Maximum Operating Temp: 80°C Never to Exceed: 1000 kPa



*Please note: Specifications are subject to change without notice. It is the responsibility of the installer to check the measurements of the physical product before installation*