

# TuffBase™ | 3-Sided Tray

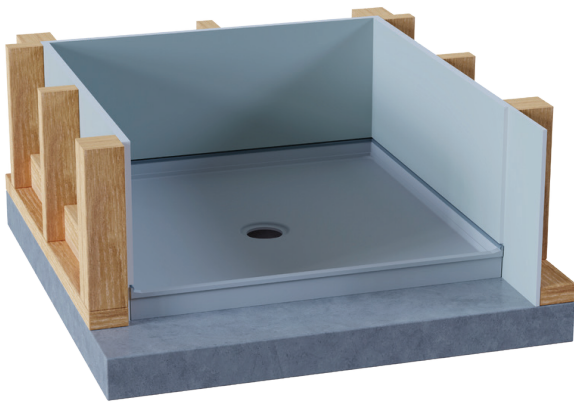

## PRODUCT FEATURES

- Can sustain a point load of 350kg+
- 50 year structural warranty
- AquaCheck to prevent capillary action
- Designed for vinyl coving
- Suitable with TuffBase Wall Lining or Hardies
- Suits 90mm Waste
- Can be used with a shower curtain or screen
- Coving detail prevents water migration.
- Protected and licensed under patent no.798686.

## TRAY DETAILS & FITTING

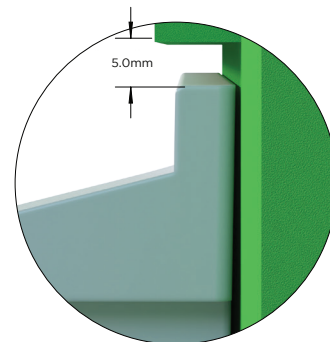
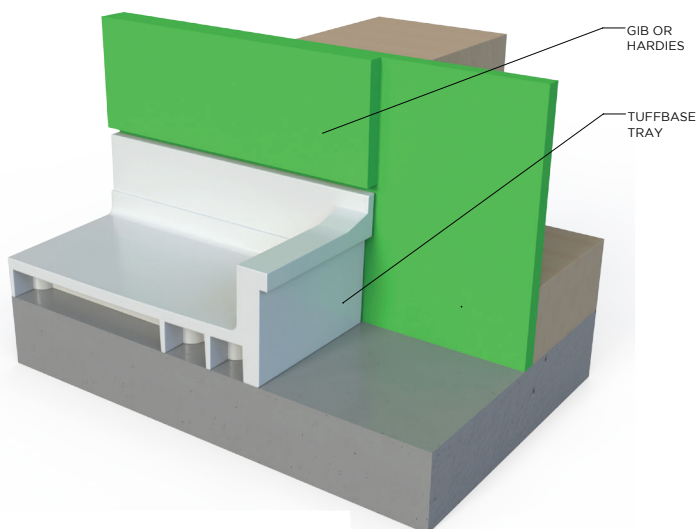
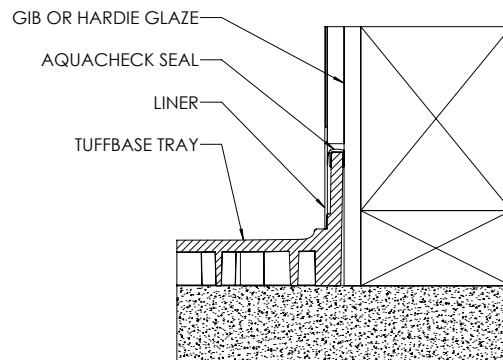
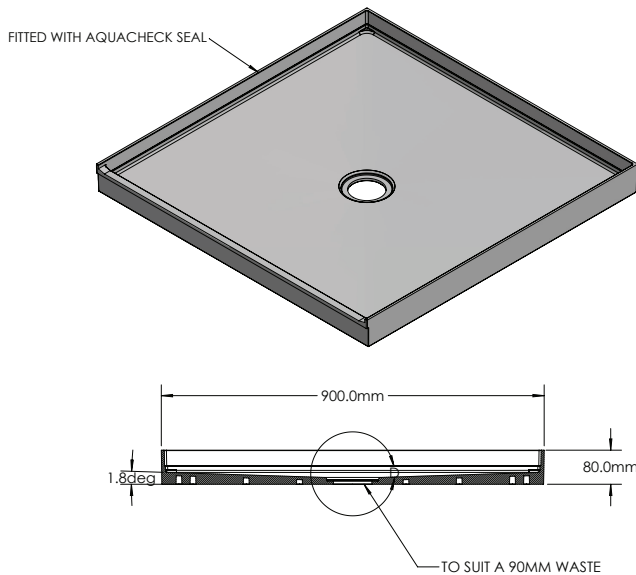

## TRAY ADHESIVES

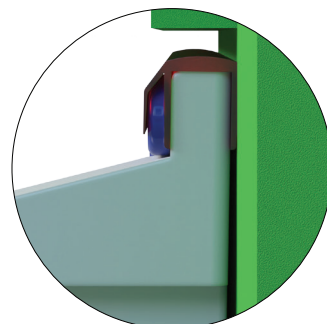
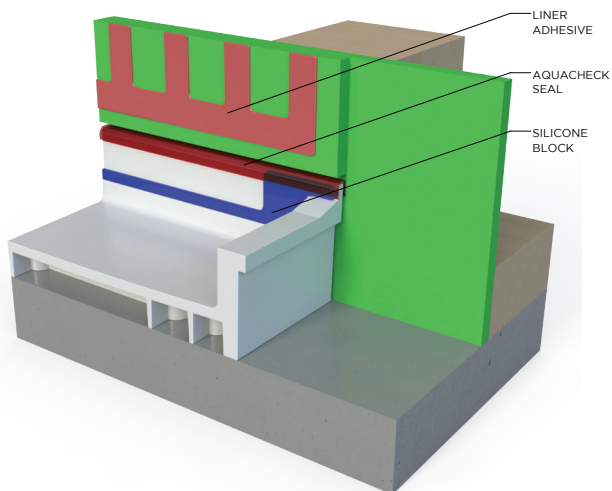

## TRAY LINER AND LINER TRIM

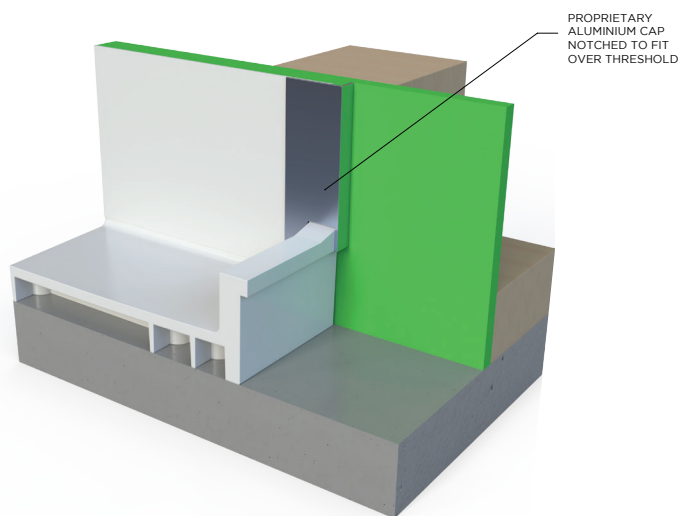
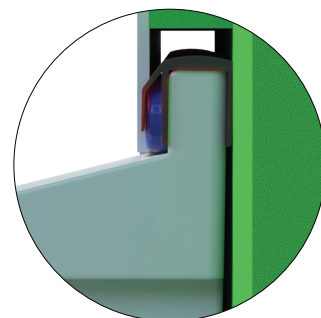
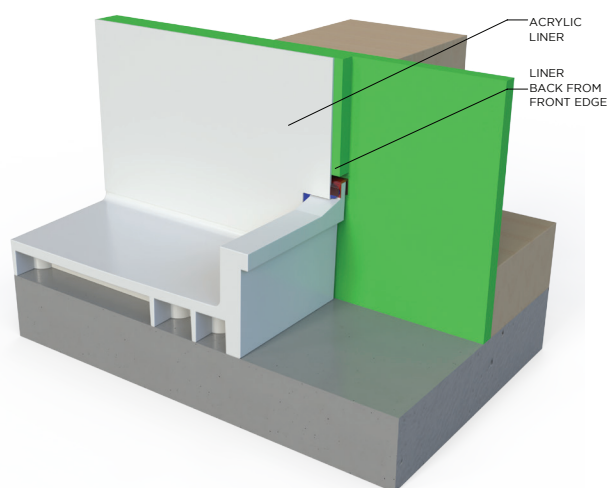

VIEW FROM INSIDE TRAY

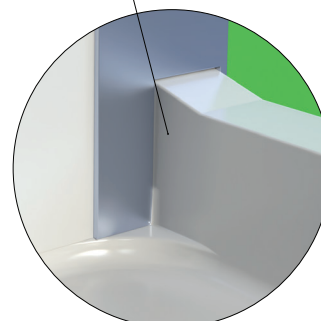

\*Capping is available separately. Please note this is only the height of the shower liner.

## TRAY VINYL

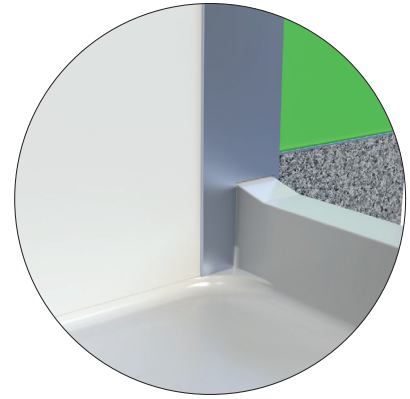
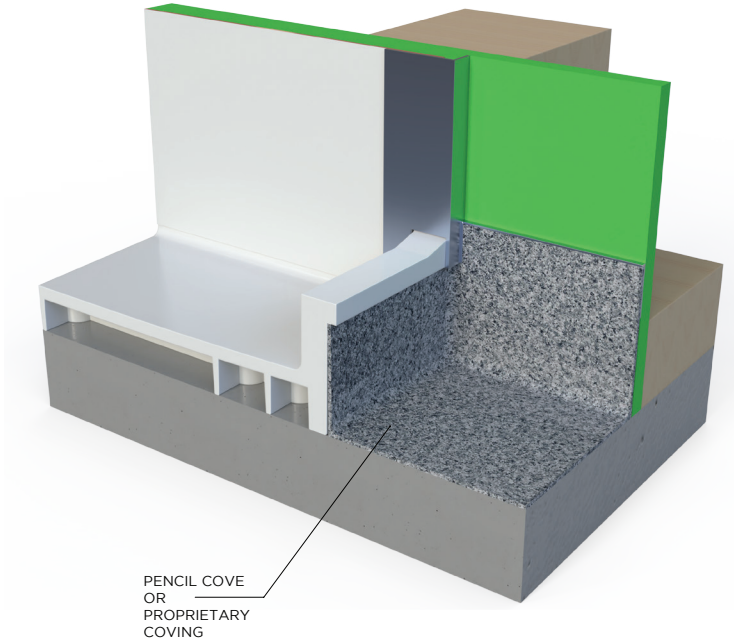

## TRAY INSTALL

1. TRAY



2. ADHESIVE AND SILICONE

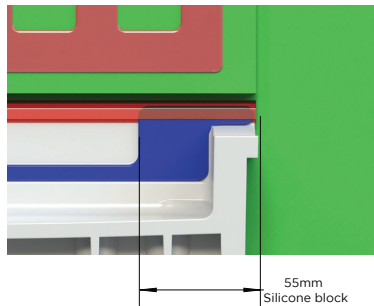

3. WALL LINING



4. ALUMINIUM TRIM



5. VINYL



### DESCRIPTION:

The TuffBase tray is a 900x900mm Centre Waste 3-Sided acrylic shower tray, that is engineered to withstand the toughest of loads. With a 350kg point load rating, the TuffBase tray is designed for use with double layer of GIB. Vinyl flooring is used with the TuffBase system, coving up the front of the tray. The system is suitable for use with a shower curtain, and is provided with an easy clean waste and a brass plated waste cap.

The TuffBase system features the AquaCheck seal technology across the top of the tray upstand that creates an anti-capillary gap, meaning there is no provision for water tension to elevate the liquid up behind the acrylic liner.

### CONTRIBUTIONS TO COMPLIANCE

E3.3.5 and E3.36: TuffBase Acrylic trays are suitable for use with two layers of GIB, where one extends behind the tray, and one reaches to the top of the tray upstand. Silicone is applied to the tray upstand, and as the tray features AquaCheck technology, an anti-capillary gap is created, preventing water migration behind the wall lining.

B2.3.1(c)(i) and (ii) and B2.3.2 (b): The Newline TuffBase system has a warranted structural durability of 50 years. Refer to installation instructions and Aftercare Document for more information.

G1.1 (a) and G1.3.2: TuffBase trays are made from easy clean, anti-slip acrylic. Regular cleaning routines to maintain hygiene standards are outlined in Aftercare and maintenance document. Trays require adequate disposal via waste outlets, refer to installation manual for further information.

### SCOPE OF USE

TuffBase trays are intended for use in the following environments:

- Domestic and commercial bathrooms, including homes, government and social housing, hotels and apartments.
- Suitable for use with cold and hot water.
- Used on a level floor surface that has been prepared as per installation instructions.
- Suitable with double layer of GIB, vinyl coving and shower curtain.
- Can be used with a TuffBase Wall Lining or Hardies.

### CONTACT DETAILS

Location: NZ for Local and Imported Products

Legal and Trading Name of Manufacturer:  
Newline Group Ltd

Importer Address for Service:  
54 Unutoto Place, Tauranga, 3171

Importer Website: [newline.nz](http://newline.nz)

Importer Email: [info@newline.co.nz](mailto:info@newline.co.nz)

Importer Phone Number: 0508 NEWLINE

### CONDITIONS OF USE

- Newline acrylic trays are intended for use under regulated water temperature that does not exceed 55 degrees Celsius.
- Must be installed in accordance with Newline Acrylic Wall and Tray Installation Manual.
- Cleaning products including bleaches, solvents, alcohol, citrus based chemicals, bath oils, and/or any abrasive cleaner shouldn't be used. Full list is outlined in Aftercare Document.
- Should be installed by an experienced shower installer or tradesman to ensure best outcome.

### WARNINGS AND BANS

This product is not subject to warning or bans under section 26 of the Building Act 2004.

### SUPPORTING DOCUMENTATION

The following additional documentation supports the above statements:

[Aftercare and Maintenance Doc](#)

[Warranty Information](#)

[TuffBase Instruction Manual](#)