

## Flute Round Vessel Basin

Code: FL40

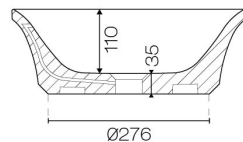
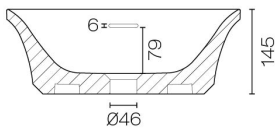
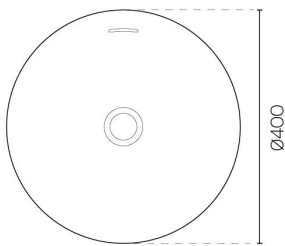

<b>Brand</b>	Claybrook
<b>Colour</b>	Black, Blue, Green, Grey, Matt White, Red, Cream
<b>Material</b>	Marbleform
<b>Type</b>	Bench Mount and Inset Basins
<b>Installation</b>	Bench Mount
<b>Height (mm)</b>	145
<b>Diameter (mm)</b>	Ø400
<b>Warranty</b>	10 Years
<b>Overflow</b>	Yes
<b>Waste Size</b>	32mm
<b>Waste Included</b>	No
<b>Material</b>	Marbleform
<b>Approx Lead Time</b>	10-12 weeks may apply for some colours. Please enquire for accurate leadtime.
<b>Other Information</b>	Made from Marbleform, a high performance stone compound. Manufacturing process includes 3 days of manual sanding and hand finishing. Soft touch and feel, non porous, repairable and easy to clean.

Scan to View  
Product Online



# Flute Round Vessel Basin

Code: FL40

## Building Product Information Requirements (BPIR)

<b>Manufacturer</b>	Plumblin
<b>Building Code Clauses</b>	B2 (Durability) B2.3.1 (c) / G13 (Foul Water) G13.3.1
<b>Compliance Evidence</b>	Clauses relating to this product are aimed at the installer. Please find comprehensive installation instructions on the product information page. The product is designed to enable the installer to comply with the building code. The product complies with the clause B2 (Durability) B2.3.1 (c).
<b>Condition of Use</b>	For use in residential and commercial applications. Must be installed by a registered plumber or suitably qualified tradesperson and as per the installation instructions.
<b>Version no.</b>	1.0
<b>Subject to a Warning</b>	No

Scan to View  
Product Online

