

INSTALLATION INSTRUCTIONS

progetto
DESIGN COLLECTION

TUBE/SWISS KITCHEN MIXER WITH PULL-OUT SPRAY

TU0700 | SW0106.BS

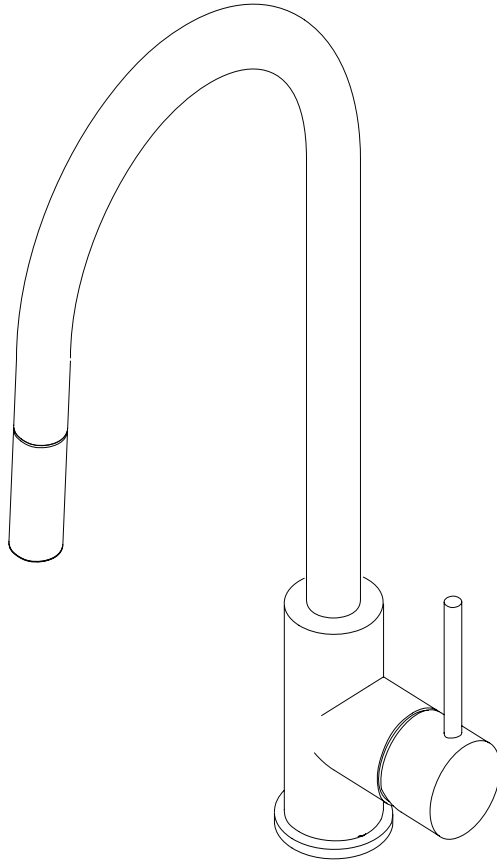

IMPORTANT!

Please read these instructions **prior** to installation

Distributed by:

Plumbline

T 04 568 9898 E sales@plumblin.co.nz
www.plumblin.co.nz

RECOMMENDATIONS FOR INSTALLATION



ATTENTION: Failure to follow these recommendations may void the warranty. It is recommended that a qualified, licensed tradesperson install this product.

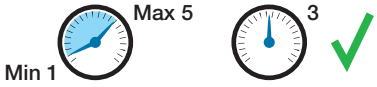

Water Pressure: 3 bar

Product performance cannot be guaranteed if pressure is less than 1 bar. Above 5 bar a pressure regulator must be installed. Failure to do so voids the product warranty.

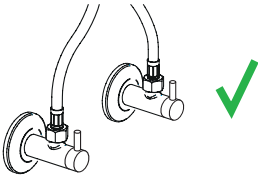

Stop Taps/Filters

Angle valves and/or filters are recommended to prevent impurities and debris entering the mixer.

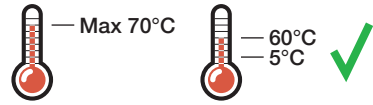

Water Temperature: 5°- 60°C

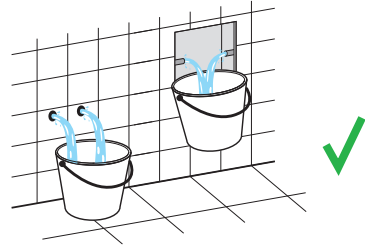

Pre-Flush

Always flush out the pipework before connecting any tapware. Failure to do so voids the product warranty.

Flexible Hoses

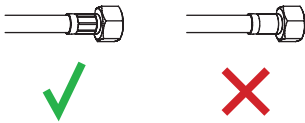

Before installation check that both end fittings of the flexible hoses are well tightened/cripped. If in doubt do not install the flexible hose.

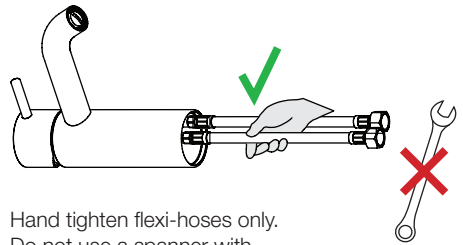

Hand tighten flexi-hoses only. Do not use a spanner with excessive force.

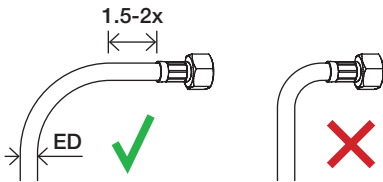

Before any bends ensure there is a straight section of the flexible hose from the hose crimp of at least 1.5-2 times the external (ED) diameter of the hose.

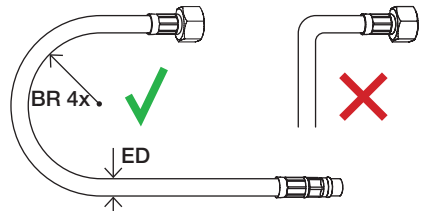

Flexible hose bending radius (BR) should be less than four times the external diameter (ED) of the hose. Do not install with any tension, twists, pinch points or sharp bends/kinks.

CLEANING & MAINTENANCE

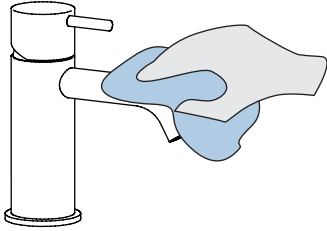

Cleaning

Clean with warm soapy water and a smooth cloth. Avoid abrasive sponges or detergents as these will damage the finish.

To preserve the finish it is recommended to apply a stainless steel oil/mineral oil on a monthly basis.

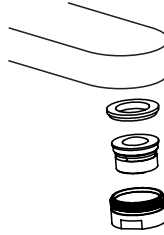

Aerator Maintenance

Remove the aerator, either with a spanner or an aerator cartridge key.

Immerse for half a day in water-vinegar solution (80-20%).

Wash, then reassemble.

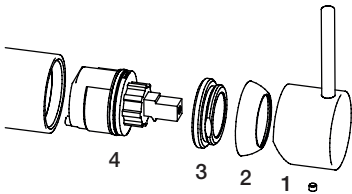

Cartridge Replacement

Before you start, turn off the water supply to the mixer.

1. Remove the handle
2. Unscrew the dome (hand tightened)
3. Unscrew the locking nut
4. Remove the cartridge

Re-assemble in reverse order

⚠ Max tightening torque on locking nut: 10-12 Nm

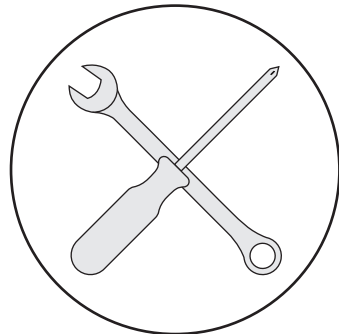

Warranty Information

For full details about our warranty visit plumbline.co.nz/warranty-information

INSTALLATION INSTRUCTIONS

progetto

- 1 Insert the flexible hoses, remembering to hand-tighten only.

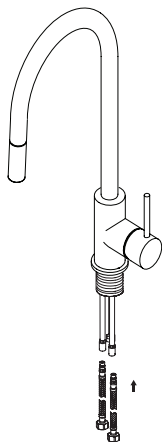

- 2 Insert the mixer unit/hoses into the taphole.

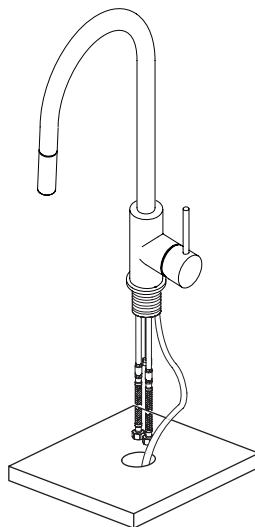

- 3 Slide on the rubber and steel washers, then tighten fixing nut with a spanner while holding the mixer in the desired position.

This step may require two people.

 Do not over tighten the nut!

Use locking screws on flange nut as required.

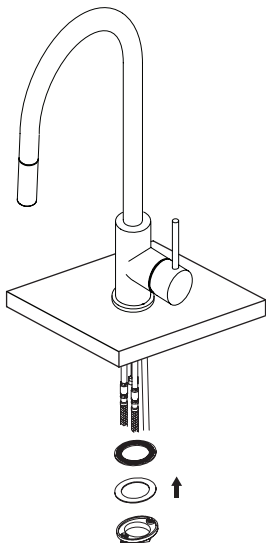

- 4 Insert the supplied washer and connect up the pull-out hose to the copper tail.



- 5 Tighten the weight to the pull-out hose, to ensure the the pull-out hose functions correctly, the weight must be installed the opposite side to where the hose connects to the copper tail as shown below.

Note: Ensure other hoses/cords are restrained and do not conflict with the pull-out hose action.

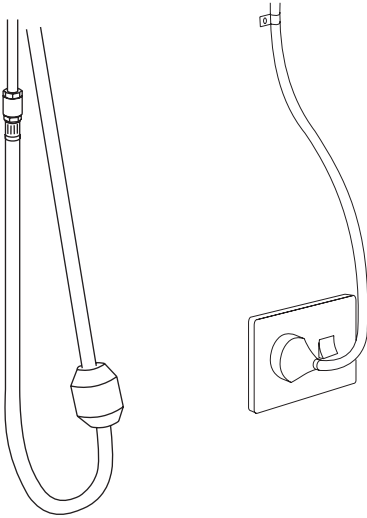

- 6 Finally connect up the flexible hoses and turn on the water.

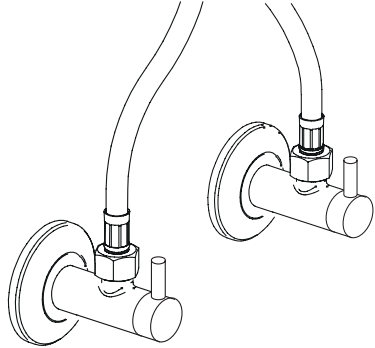

Test the unit for performance.

