

Important

The basin mixer is designed for equal and unequal pressure systems

Recommended pressure range 150 to 500kpa, minimum pressure 35kPa, maximum pressure 1000kPa.

Recommended water supply temperature range is 5 to 65°C, maximum 80°C. Products not recommended for uncontrolled heating situations such as wetbacks or solar heating units unless a NEFA tempering valve is fitted. AS/NZS 3500 requires all hot water supplies to any sanitary fittings to be tempered to 55°C for NZ, and 50°C for Australia.

All pipework must be thoroughly flushed prior to installation of the mixer. NEFA inline filters must be installed on both the hot and cold supply lines.

When installing the single lever mixer do not remove the ceramic cartridge.

Installation Instructions

Unequal Pressure Installations

Screw the nipple with the flow restrictor to the cold inlet flexible hose.

Equal Low Pressure Installations

Remove the flow restrictor from the brass nipple pushing it out with a suitable blunt instrument. Screw the brass nipples to the flexible hoses.

Equal High Pressure (Mains) Installations

Install mixer without modification. Remove the flow restrictor from the brass nipple by pushing it out with a suitable blunt instrument. Screw the brass nipples to the flexible hoses. A stainless steel aerator is supplied and can be fitted if required using the O ring to seal.

Installation

A 1 ¼" (32mm) diameter hole is required in the bench top. The bench top cannot exceed 40mm thick.

Screw the mounting stud into the bottom of the basin mixer.

Connect the flexible hoses to the mixer body. Fi

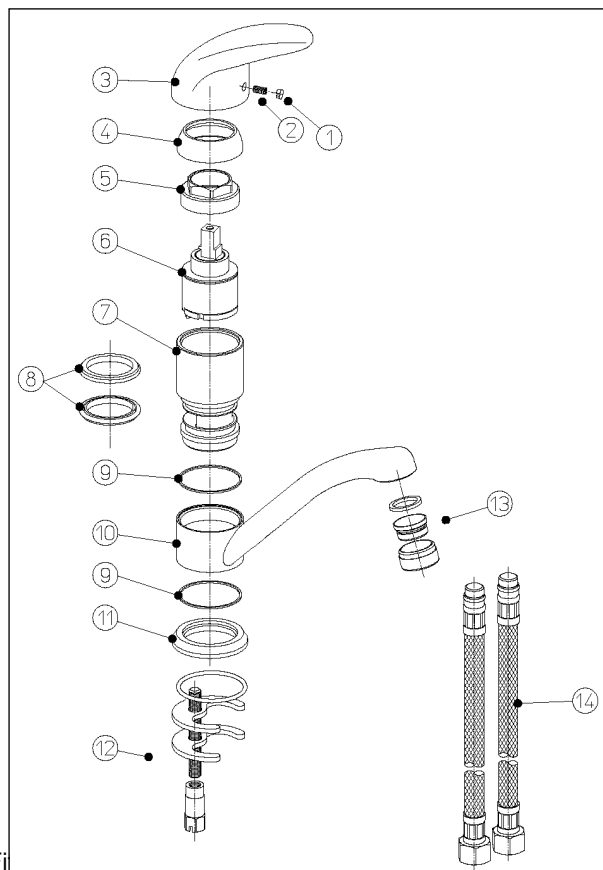

Place the hoses 14 through the hole in the bench top. Position the mixer centrally in the hole in the bench top, ensuring the base ring O ring seals completely around the outside of the bench hole.

Fit the mounting gasket, mounting plate and tighten the mounting nut.

If fitting to an unequal pressure situation connect the brass nipple supplied, containing the flow restrictor, to the cold inlet hose. If fitting to an equal low or equal high pressure situation remove the flow restrictor from the brass nipple before screwing the nipples to the hoses.

2 rubber washers are provided for the flexible hose connections to the nipples. Machined nipple ends are required to ensure a seal to the flexible hose nuts and the rubber washers.

Two rubber washers are provided for the flexible hose connections to the nipples. Machined nipple ends are required to ensure a seal to the flexible hose nuts

Flexible Hose Requirements

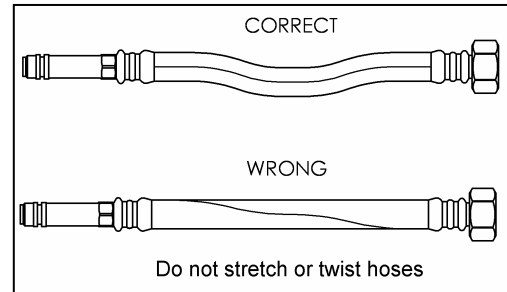
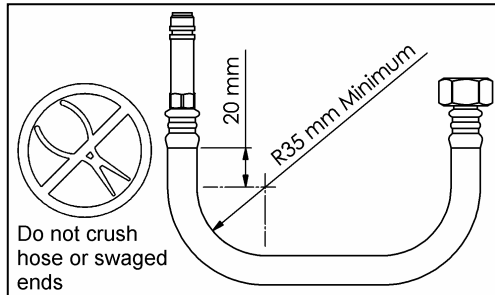

METHVEN LIMITED

For your warranty please refer to www.methven.biz or call Customer Services

New Zealand
0800 804 222

Australia
1 800 035 330

USA
800 975 5409