

CELESTE BATH MIXER

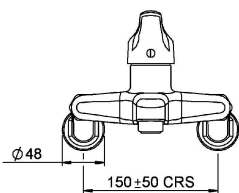
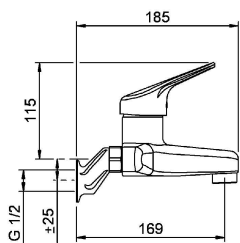

CONSTRUCTION: Brass body

CARTRIDGE TYPE: SP033550 ceramic cartridge

CLASSIFICATION: Suitable for **all pressures**

INLET CONNECTIONS: 1/2" BSP

WORKING PRESSURE: 35 - 1000kPa

DIMENSIONS FOR FITTING: 48mm diameter holes

OPERATING TEMPERATURE: 5 °C - 80 °C

- Exposed eccentrics as standard
- Flow director and aerator supplied for spout outlet
- Removable flow restrictor on cold outlet
- NEW handle design

TP2080CP2

Chrome

<http://www.methven.com/nz/celeste-bath-mixer>