

# WAVE Soltero

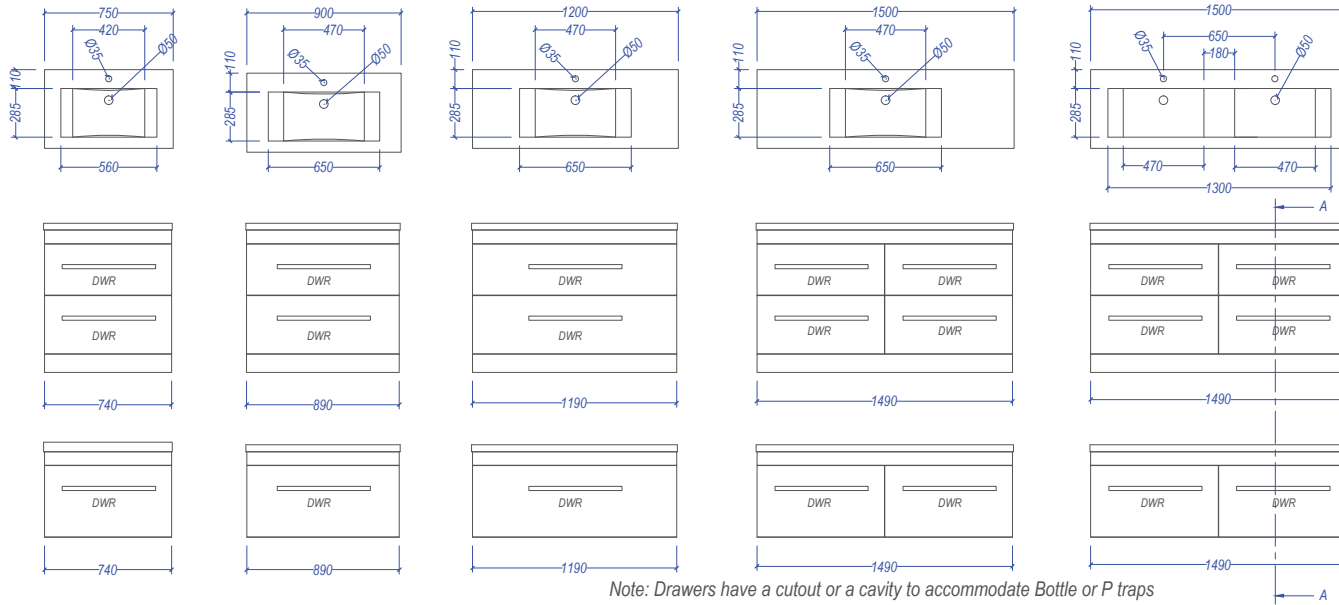

Note: Drawers have a cutout or a cavity to accommodate Bottle or P traps

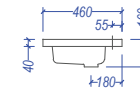

Internal Basin Depth  
130 mm

Section AA

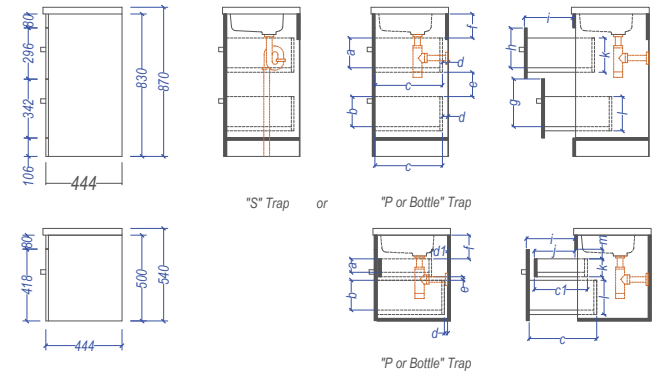

Internal drawer of Soltero Wall Hung



Top & Bottom Drawer on Soltero Floor Standing  
Bottom drawer on Soltero Wall Hung

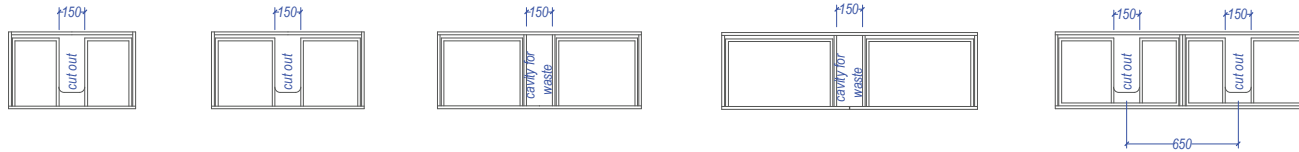

Note: Drawers have a cutout or a cavity to accommodate Plumbing

Nominal Dimensions in mm															
	a	b	c	ct	d	d1	e	f	g	h	i	j	k	l	m
Floor Standing	174	174	393		30		142	158	295	250	280		200	200	80
Wall Hung	78	174	393	310	20	95	20	140			283	240	105	200	56