

CAVIUS™

THE WORLD'S
SMALLEST
smoke alarm

10YEAR
LONGLIFE BATTERY

PLEASE READ THIS USER GUIDE CAREFULLY





Cavius DIY Smoke Alarm
Model 2008-002 / 10012 / 10013 / 10014
Manufactured by CAVIUS

**PLEASE READ THE USER
GUIDE CAREFULLY BEFORE
INSTALLATION AND RETAIN
FOR FUTURE USE.**

For large text option and maintenance guide visit
www.cavius.co.nz/resources
www.cavius.com.au/resources

THE WORLD'S
SMALLEST
smoke alarm

The CAVIUS™ is smoke alarm is a photoelectric alarm designed to be installed into residential homes, camper-vans and caravans.

It is not recommended for boats.
CERTIFIED TO AUSTRALIAN STANDARD
AS3786:2014



The best locations in your home to install the smoke alarm:

- Place a smoke alarm between possible fire sources and bedrooms as a minimum.
- Smoke alarms on each floor, in hallways and stairways.
- Smoke alarms in each room such as bedrooms and living rooms.

Additional smoke alarms will increase the security. The NZ and Australian Fire Services recommend smoke alarms in every bedroom, hallway and living area for early fire detection.



 **MINIMUM
INSTALLATION**

 **OPTIMUM
INSTALLATION**



Installation of smoke alarm:

Info: The label in the product must not be removed due to important information regarding the product.

1. Use the mounting base ring to mark the screw holes on the ceiling. Use the enclosed screws and plugs for installing the mounting base.

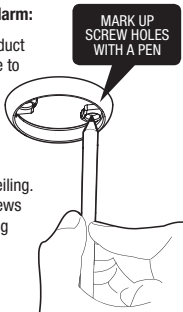

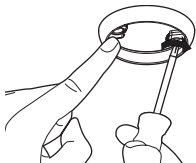

USE THE
ENCLOSED
SCREWS AND
PLUGS FOR
INSTALLATION

CLICK THE SMOKE
ALARM FIRMLY INTO
THE BASE TO ACTIVATE

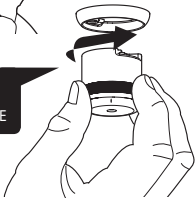

Placement: Designed for placement on ceiling (preferred) or wall. The smoke alarm should be a minimum 50 cm from the wall, with a minimum of one smoke alarm per floor and a maximum distance between smoke alarms of 10 metres.

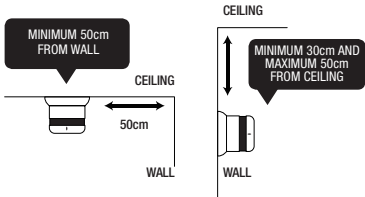

2. After mounting, allow 5 seconds for the alarm to power up and then test the smoke alarm by pushing the test button (which is the entire top of the alarm). The alarm should produce a loud sound

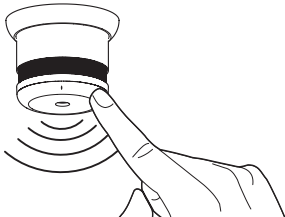

The smoke alarm may NOT be placed:

- In dusty rooms
- At the top of high pointed ceilings, instead place a minimum of 50cm to a maximum of 150 cms from the apex.
- Within 50cm of a wall.
- In rooms where the temperature goes outside +5° to 45°C or above 90% relative humidity non condensing.
- In kitchens, garages, or too close to fireplaces.
In areas that get damp or where gases may occur.

*Place the smoke alarm where it is reachable
in order to test the battery and complete maintenance.*

Maintenance: The smoke alarm should be vacuum cleaned once per quarter, and can be wiped with a slightly damp cloth (do not open the alarm).

Test the smoke alarm once per month by pushing the test button.

The smoke alarm should produce a loud alarm tone.

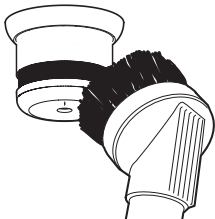

FUNCTIONAL INFORMATION

Type of alarm: CAVIUS™ smoke alarm is a photo electric smoke alarm.

Alarm signal: Fire alarm activation is indicated by a series of repeated tones. The minimum sound level is 85 dB at 3 metres.

Battery: Powered by a non-replaceable 3v CR123 A DURACELL Lithium battery with 10-year life (included).



Low battery indicator: A short acoustic “beep” will sound and the LED will flash every 48 seconds when the battery is near the end of its life. In this stage it will continue for a minimum of 30 days.

You must change the smoke alarm after 10 years of use, or if the smoke alarm has suffered any damage. The smoke alarm is not active unless it is clicked into the mounting base.

Always test the smoke alarm after clicking into the mounting base, allow 5 seconds before testing.

10YEAR
LONGLIFE BATTERY

Smoke alarm signal: The smoke alarms have a visual and acoustic signal. In the passive state, the LED will flash every 48 seconds to indicate normal function. In alarming state the LED will flash and the alarm will emit a sweeping sound pattern designed to alert occupants.

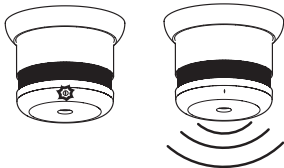

Hush function: In case of unintentional or false alarms, press the hush button for 2 seconds (which is the entire bottom of the alarm). This will mute the alarm for 10 minutes, after which time the alarm will automatically resume its normal function.

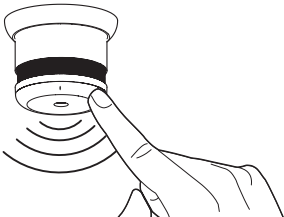

Fault finding: If the smoke alarm activates without a visible smoke or fire presence, then possible causes could be:

- Dust particles which have entered the smoke chamber, these can be removed by vacuuming around the mesh.

If the smoke alarm does not work when the test button is pushed, please check our Trouble Shooting Guides at;

www.cavius.co.nz and www.cavius.com.au

Other information:

- Do not paint the smoke alarm.
- Note the local country regulations regarding installation of mains powered smoke alarms in new buildings.

Disposal: For battery and product, please dispose properly at end of life. This is electronic waste that should be recycled.

MANUFACTURED BY:

CAVIUS Aps

Julsøvej 16 - DK8600 Silkeborg

www.cavius.com - info@cavius.com

Manufactured in P.R.C.

DISTRIBUTOR INFORMATION:

CAVIUS Nano Ltd. 8 King Street, Te Puke. 3119,
Bay Of Plenty 3118. P.O Box 11241, Palm Beach Plaza,
Papamoa, Bay Of Plenty 3151, New Zealand.

www.cavius.co.nz

Hotline: 0800 766533 or 07 542 2191

REP ELEC.

Locked Bag 45, Plumpton, NSW 2761, Australia.

www.cavius.com.au - PH: 1300 555 586

Warranty:

Your CAVIUS™ smoke alarm has a 5 year warranty from the date of purchase against defect in material and workmanship. Faulty units during this period can be returned to the place of purchase. You must provide the proof of purchase date and such defects will be repaired, or replaced at the distributors option, without charge. This Warranty only covers defects in materials or workmanship in normal residential use and does not cover damage resulting from negligent handling, misuse or lack of reasonable care. This warranty is in lieu of any other warranty either expressed or implied.



AS3786:2014

Model Number 2008-002 / 10012 / 10013 / 10014

Product overview:

Type of mounting

☒ Ceiling and Wall
Mounting

Main power supply

☒ Internal power
source
(battery included)

Battery duration

☒ 10 years

Interconnectable device

☐ Yes ☒ No

Suitable for installation
in mobile home

☒ Yes ☐ No

.....

Connection to external
auxiliary devices

☐ Yes

☒ No

.....

Radio link

☐ Yes

☒ No

.....

Individual alarm indicator

☒ Yes

☐ No

.....

Alarm silence facility
(10min)

☒ Yes

☐ No

.....

No radioactivity
infrared technology

☒ Yes

☐ No

.....

Accessibility option

☐ Yes

☒ No

.....



CAVIUS™